

Tuerca Remache Acero Cab./ Reducida moleteada

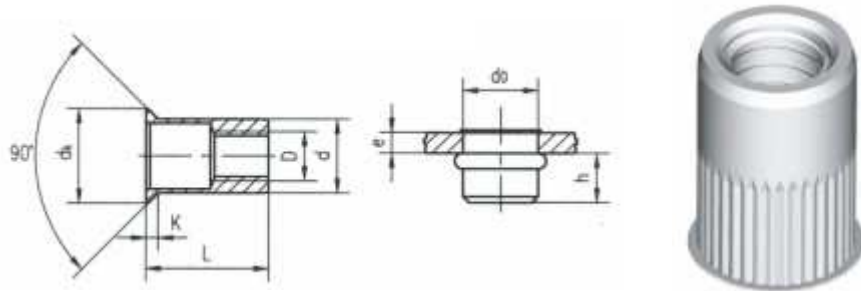

ACERO SAE 1010 ROSCA METRICA MA								
Codigo	Diam.	e	h(ref.)	Agujero d. d _k +0.15 +0.25	d -0.03 -0.20	d _k +/-0.30	K +/- 0.20	L +/- 0.30
URSP3030	M 3	0.5-2.0	5.0	5	5	5.50	0.35	8.5
URSP3040	M 4	0.5-2.0	6.5	6	6	6.75	0.50	10.0
URSP3050	M 5	0.5-2.5	8.0	7	7	7.90	0.60	12.0
URSP3060	M 6	0.5-3.0	9.5	9	9	10.00	0.60	14.5
URSP3080	M 8	0.5-3.5	10.5	11	11	12.40	0.70	16.5
URSP3100	M 10	0.5-3.5	13.0	13	13	14.50	0.95	19.0
URSP3120	M 12	0.5-3.5	16.0	15	15	16.50	0.95	22.5

ACERO SAE 1010 ROSCA EN PULGADAS U.N.C.								
Codigo	Diam.	e	h(ref.)	Agujero d. d _k +0.15 +0.05	d -0.03 -0.20	d _k +/-0.30	K +/- 0.20	L +/- 0.30
URSP1047	Nº 10	0.5-2.5	8.0	7	7	8	0.6	12.0
URSP1063	1/4	0.5-3.0	9.5	9	9	10	0.6	14.5
URSP1079	5/16	0.5-3.5	10.5	11	11	12.3	0.6	16.5
URSP1095	3/8	0.5-3.5	13.0	13	13	14.5	0.85	19.0

Tuerca Remache Inoxidable 304 Cab./ Reducida moleteada

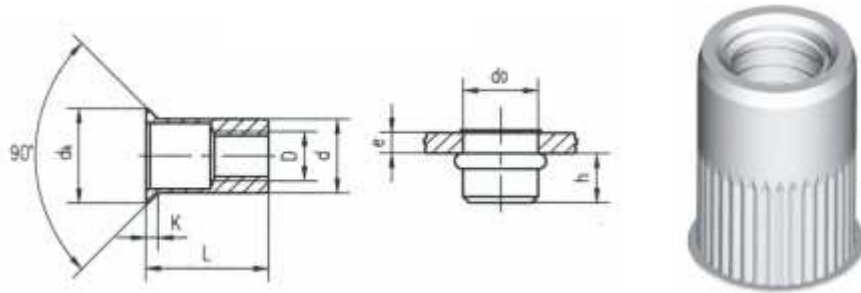

INOXIDABLE AISI 304 ROSCA METRICA MA								
Codigo	Diam.	e	h(ref.)	 Agujero d _i	d	d _k	K	L
				d _i +0.16 +0.05	-0.03 -0.20	+/-0.30	+/- 0.20	+/- 0.30
URIP3030	M 3	0.5-2.0	4.5	5	5	6.0	0.5	9.5
URIP3040	M 4	0.5-2.0	6.5	6	6	7.0	0.5	11.3
URIP3050	M 5	0.5-2.5	8.0	7	7	8.0	0.5	12.4
URIP3060	M 6	0.5-3.0	9.0	9	9	10.0	0.5	14.3
URIP3080	M 8	0.5-3.5	11.5	11	11	12.0	0.5	16.4
URIP3100	M 10	0.5-3.5	12.5	13	13	14.3	0.8	19.7